

2500 lb flange

welding neck

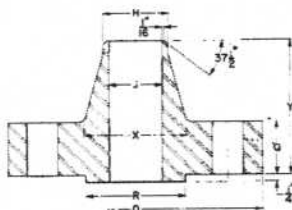

threaded

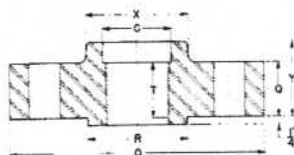

manufacture: ★150 lb flanges are carbon steel furnished to ASTM specifications A105 grade 1. ASTM A105 is the same as Boiler Construction Code Specification SA105. Flanges furnished faced, drilled, and spot faced or back faced

dimensions: All dimensions are in inches and in accordance with ASA B16.5 where applicable. 22 inch is an interpolated dimension as given in MSS-SP-44. Sizes 26" to 42" have same flange drilling dimensions as 125 lb class cast iron flanges, ASA B16.1.

◆Flanges bored to dimensions shown, unless otherwise specified. Dimensions shown correspond to ASA B36.10 inside diameter of standard wall pipe.

+ Thread lengths for 150 lb flanges are American Standard for Pipe Threads ASA B2.1. Add depths or height of facing to thread length.

+ Length shown does not include thickness of lap. For lapped to lapped, add thickness of both laps; for lapped to 1/16 inch raised face add one thickness of lap; for lapped to any other facing, add amount that such facing and one lap will cause the flanges to be separated.

nominal pipe size	outside diam. of flange O	thick-ness of flange Q (min.)	diam. of raised face R	diam. of hub at base X	no. of bolt holes	diam. of bolts ^a	diam. of bolt circle	length of stud bolts ^b			length thru hub		
								1/4" raised face	ring joint	male & female, tongue & groove	welding neck Y	slip-on, thrd Y	lap joint Y
1/2	5 1/4	1 3/8	1 3/8	1 1/8	4	3/4	3 1/2	4 3/4	4 3/4	4 1/2	2 3/8	1 3/8	1 3/8
3/4	5 1/2	1 1/4	1 1/8	2	4	3/4	3 3/4	4 3/4	4 3/4	4 1/2	3 3/8	1 1/8	1 1/8
1	6 1/4	1 3/8	2	2 1/4	4	7/8	4 1/4	5 1/4	5 1/4	5	3 1/2	1 3/8	1 3/8
1 1/4	7 1/4	1 1/2	2 1/2	2 7/8	4	1	5 1/8	5 3/4	6	5 1/2	3 3/4	2 1/8	2 1/8
1 1/2	8	1 3/4	2 3/8	3 3/8	4	1 1/8	5 3/4	6 1/2	6 3/4	6 1/4	4 3/8	2 3/8	2 3/8
2	9 1/4	2	3 3/8	3 3/4	8	1	6 3/4	6 3/4	7	6 1/2	5	2 3/4	2 3/4
2 1/2	10 1/2	2 1/4	4 1/8	4 1/2	8	1 1/8	7 3/4	7 1/2	7 3/4	7 1/4	5 5/8	3 3/8	3 3/8
3	12	2 5/8	5	5 1/4	8	1 1/4	9	8 1/2	8 3/4	8 1/4	6 5/8	3 3/8	3 5/8
4	14	3	6 3/16	6 1/2	8	1 1/2	10 3/4	9 3/4	10 1/4	9 1/2	7 1/2	4 1/4	4 1/4
5	16 1/2	3 3/8	7 3/16	8	8	1 3/4	12 3/4	11 1/2	12 1/4	11 1/4	9	5 1/8	5 1/8
6	19	4 1/4	8 1/2	9 1/4	8	2	14 1/2	13 1/2	14	13 1/4	10 3/4	6	6
8	21 3/4	5	10 5/8	12	12	2	17 1/4	15	15 1/2	14 3/4	12 1/2	7	7
10	26 1/2	6 1/2	12 3/4	14 3/4	12	2 1/2	21 1/4	19	20	18 3/4	16 1/2	9	9
12	30	7 1/4	15	17 3/8	12	2 3/4	24 3/4	21	22	20 3/4	18 1/4	10	10

2500 lb flange

lap joint

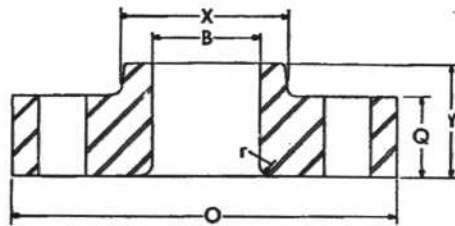

slip-on

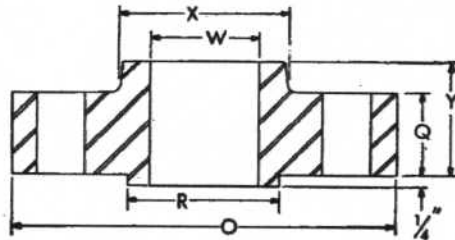

blind

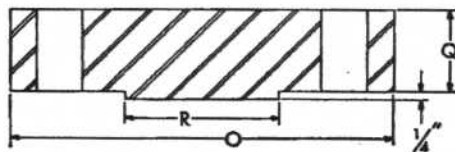

nominal pipe size	diameter of bore				minimum thread length T+	diam. of hub at point of welding H	radius r	weight (approx.) lb			
	threaded counter bore C	lap joint B	slip-on W	welding neck J±				welding neck	slip-on and th'rd	lap joint	blind
1/2	.93	.90	.88		1 1/8	.84	1/8	8	7	7	7
3/4	1.14	1.11	1.09	as	1 1/4	1.05	1/8	9	9	8	10
1	1.41	1.38	1.36		1 3/8	1.32	1/8	13	12	12	12
1 1/4	1.75	1.72	1.70	speci-	1 1/2	1.66	3/16	20	18	17	18
1 1/2	1.99	1.97	1.95		1 3/4	1.90	1/4	28	25	24	25
2	2.50	2.46	2.44	fied	2	2.38	5/16	42	38	37	39
2 1/2	3.00	2.97	2.94		2 1/4	2.88	3/16	52	55	53	56
3	3.63	3.60	3.57	by	2 1/2	3.50	3/8	94	83	80	86
4	4.63	4.60	4.57		2 3/4	4.50	3/8	146	127	122	133
5	5.69	5.69	5.66	pur-	3	5.56	3/16	244	210	204	223
6	6.75	6.75	6.72		3 1/4	6.63	1/2	378	323	314	345
8	8.75	8.75	8.72	chaser	3 3/4	8.63	1/2	576	485	471	533
10	10.88	10.92	10.88		4 1/4	10.75	1/2	1068	925	897	1025
12	12.94	12.92	12.88		4 3/4	12.75	1/2	1608	3100	1262	1464