

600 lb. flange

welding neck

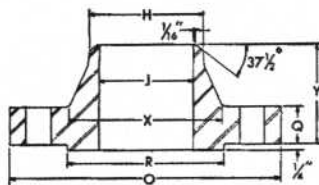

threaded

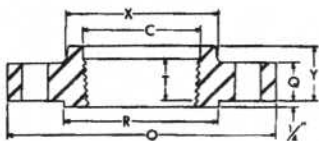

manufacture: ★150 lb flanges are carbon steel furnished to ASTM specifications A105 grade 1. ASTM A105 is the same as Boiler Construction Code Specification SA105. Flanges furnished faced, drilled, and spot faced or back faced

dimensions: All dimensions are in inches and in accordance with ASA B16.5 where applicable. 22 inch is an interpolated dimension as given in MSS-SP-44. Sizes 26" to 42" have same flange drilling dimensions as 125 lb class cast iron flanges, ASA B16.1.

◆Flanges bored to dimensions shown, unless otherwise specified. Dimensions shown correspond to ASA B36.10 inside diameter of standard wall pipe.

→Thread lengths for 150 lb flanges are American Standard for Pipe Threads ASA B2.1. Add depths or height of facing to thread length.

→Length shown does not include thickness of lap. For lapped to add one thickness of lap; for lapped to any other facing, add amount that such facing and one lap will cause the flanges to be separated.

nominal pipe size	outside diam. of flange O	thick-ness of flange Q (min.)	diam. of raised face R	diam. of hub at base X	no. of bolt holes	diam. of bolts ^W	diam. of bolt circle	length of stud bolt ^Z			length thru hub		
								1/4" raised face	ring joint	male & female, tongue & groove	welding neck Y	slip-on, thrd. socket Y	lap joint Y
1/2	3 3/4	3/8	1 3/8	1 1/2	4	1/2	2 5/8	3	3	2 3/4	2 1/4	3/8	3/8
3/4	4 5/8	3/8	1 7/8	1 3/8	4	5/8	3 1/4	3 3/4	3 3/4	3	2 1/4	1	1
1	4 7/8	1 1/8	2	2 3/8	4	5/8	3 1/2	3 1/2	3 1/2	3 3/4	2 3/8	1 1/8	1 1/8
1 1/4	5 1/4	1 3/8	2 1/2	2 1/2	4	5/8	3 3/8	3 3/4	3 3/4	3 1/2	2 5/8	1 1/8	1 1/8
1 1/2	6 1/8	7/8	2 3/8	2 3/4	4	3/4	4 1/2	4	4	3 3/4	2 3/4	1 1/4	1 1/4
2	6 1/2	1	3 3/8	3 3/8	8	3/8	5	4	4 1/4	3 3/4	2 3/8	1 3/8	1 3/8
2 1/2	7 1/2	1 1/8	4 1/8	3 5/8	8	3/4	5 3/8	4 1/2	4 3/4	4 1/4	3 1/8	1 5/8	1 5/8
3	8 1/4	1 1/4	5	4 3/8	8	3/4	6 3/8	4 3/4	5	4 1/2	3 3/4	1 5/8	1 5/8
3 1/2	9	1 3/8	5 1/2	5 1/4	8	7/8	7 1/4	5 1/4	5 1/2	5	3 3/8	1 5/8	1 5/8
4	10 3/4	1 1/2	6 3/8	6	8	7/8	8 1/2	5 1/2	5 3/4	5 1/4	4	2 1/8	2 1/8
5	13	1 3/4	7 3/8	7 1/8	8	1	10 1/2	6 1/4	6 1/2	6	4 1/2	2 3/8	2 3/8
6	14	1 3/8	8 1/2	8 3/4	12	1	11 1/2	6 1/2	6 3/4	6 1/4	4 5/8	2 5/8	2 5/8
8	16 1/2	2 3/8	10 5/8	10 3/4	12	1 1/8	13 3/4	7 1/2	7 3/4	7 1/4	5 1/4	3	3
10	20	2 1/2	12 3/4	13 1/2	16	1 1/4	17	8 1/4	8 1/2	8	6	3 3/8	4 3/8
12	22	2 3/8	15	15 3/4	20	1 1/4	19 1/4	8 1/2	8 3/4	8 1/4	6 1/8	3 3/8	4 3/8
14	23 3/4	2 3/4	16 1/4	17	20	1 3/8	20 3/4	9	9 1/4	8 3/4	6 1/2	3 11/16	5
16	27	3	18 1/2	19 1/2	20	1 1/2	23 3/4	9 3/4	10	9 1/2	7	4 3/8	5 1/2
18	29 1/4	3 1/4	21	21 1/2	20	1 5/8	25 3/4	10 1/2	10 3/4	10 1/4	7 1/4	4 5/8	6
20	32	3 1/2	23	24	24	1 3/8	28 1/2	11 1/4	11 1/2	11	7 1/2	5	6 1/2
22	34 1/4	3 3/4	25 1/4	26 1/4	24	1 3/4	30 5/8	12	12 1/2	11 3/4	7 3/4	5 1/4	6 7/8
24	37	4	27 1/4	28 1/4	24	1 7/8	33	12 3/4	13 1/4	12 1/2	8	5 1/2	7 1/4
26	40	4 1/4	29 1/2	29 1/4	28	1 7/8	36	13 1/4	13 3/4	-----	8 3/4	8 3/4	-----
28	42 1/4	4 3/8	31 1/2	31 3/8	28	2	38	13 3/4	14 1/4	-----	9 1/4	9 1/4	-----
30	44 1/2	4 1/2	33 3/4	33 15/16	28	2	40 1/4	14	14 1/2	-----	9 3/4	9 3/4	-----
32	47	4 5/8	36	36 1/8	28	2 1/4	42 1/2	14 3/4	15 1/2	-----	10 1/4	10 1/4	-----
34	49	4 3/4	38	38 3/8	28	2 1/4	44 1/2	15	15 3/4	-----	10 5/8	10 5/8	-----
36	51 3/4	4 3/4	40 1/4	40 3/8	28	2 1/2	47	15 3/4	16 1/2	-----	11 1/8	11 1/8	-----

600 lb. flange

lap joint

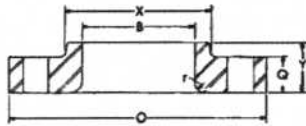

socket type

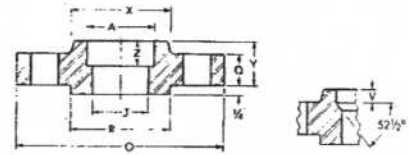

slip-on

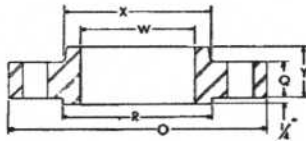

blind

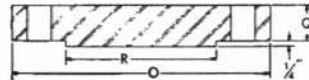

nominal pipe size	diameter of bore				minimum thread length T+	diam. of hub at point of welding H	radius r	depth of socket Z	depth of socket V	weight (approx.) lb			
	threaded counter bore C	lap joint B	slip-on socket W	welding neck socket Jφ						welding neck	slip-on and th'rd	lap joint	blind
1/2	.93	.90	.88	.55	5/8	.84	1/8	3/8	3/16	3	3	3	2
3/4	1.14	1.11	1.09	.74	5/8	1.05	1/8	7/16	3/8	4	3	3	3
1	1.41	1.38	1.36	.96	1 1/16	1.32	1/8	1/2	3/8	5	4	4	4
1 1/4	1.75	1.72	1.70	1.28	1 3/16	1.66	3/16	5/8	3/8	7	6	6	6
1 1/2	1.99	1.97	1.95	1.50	7/8	1.90	1/4	5/8	3/8	10	7	7	8
2	2.50	2.46	2.44	1.94	1 1/8	2.38	5/16	1 1/16	3/8	12	9	9	10
2 1/2	3.00	2.97	2.94	2.32	1 1/4	2.88	3/8	3/4	1/2	18	13	12	15
3	3.63	3.60	3.57	2.90	1 3/8	3.50	3/8	1 3/16	3/8	23	16	15	20
3 1/2	4.13	4.10	4.07	3.36	1 5/8	4.00	3/8	7/8	3/8	26	21	20	29
4	4.63	4.60	4.57	3.83	1 5/8	4.50	3/8	---	---	42	37	36	41
5	5.69	5.69	5.66	4.81	1 7/8	5.56	3/8	---	---	68	63	61	68
6	6.75	6.75	6.72	5.76	2	6.63	1/2	---	---	81	80	78	86
8	8.75	8.75	8.72	7.63	2 1/4	8.63	1/2	---	---	117	115	112	139
10	10.88	10.92	10.88	9.75	2 5/8	10.75	1/2	---	---	189	177	195	231
12	12.94	12.92	12.88	11.75	2 3/4	12.75	1/2	---	---	226	215	240	295
14	14.19	14.18	14.14		2 7/8	14.00	1/2	---	---	347	259	290	378
18	18.19	18.20	18.18	as	3 1/8	18.00	1/2	---	---	481	366	400	527
16	16.19	16.19	16.16		3 1/16	16.00	1/2	---	---	555	476	469	665
20	20.19	20.25	20.20		3 1/4	20.00	1/2	---	---	690	612	604	855
22	22.19	22.25	22.22	speci- fied	3 5/16	22.00	1/2	---	---	620	643	670	962
24	24.19	24.25	24.24		3 5/8	24.00	1/2	---	---	977	876	866	1175
26	---	---	26.25		---	26 1/16	---	---	---	1025	950	---	1525
28	---	---	28.25	by pur-	---	28 1/2	---	---	---	1175	1075	---	1750
30	---	---	30.25		---	30 1/2	---	---	---	1300	1175	---	2000
32	---	---	32.25		---	32 1/2	---	---	---	1500	1375	---	2300
34	---	---	34.25	chaser	---	34 3/4	---	---	---	1650	1500	---	2575
36	---	---	36.25		---	36 3/4	---	---	---	1750	1600	---	2950