

900 lb flange

welding neck

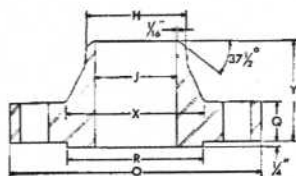

threaded

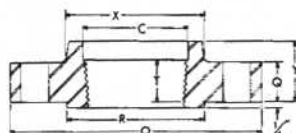

manufacture: *150 lb flanges are carbon steel furnished to ASTM specifications A105 grade 1. ASTM A105 is the same as Boiler Construction Code Specification SA105. Flanges furnished faced, drilled, and spot faced or back faced

dimensions: All dimensions are in inches and in accordance with ASA B16.5 where applicable. 22 inch is an interpolated dimension as given in MSS-SP-44. Sizes 26" to 42" have same flange drilling dimensions as 125 lb class cast iron flanges, ASA B16.1.

◆Flanges bored to dimensions shown, unless otherwise specified. Dimensions shown correspond to ASA B36.10 inside diameter of standard wall pipe.

†Thread lengths for 150 lb flanges are American Standard for Pipe Threads ASA B2.1. Add depths or height of facing to thread length.

‡Length shown does not include thickness of lap. For lapped to lapped, add thickness of both laps; for lapped to 1/16 inch raised face add one thickness of lap; for lapped to any other facing, add amount that such facing and one lap will cause the flanges to be separated.

nominal pipe size	outside diam. of flange O	thick-ness of flange Q (min.)	diam. of raised face R	diam. of hub at base X	no. of bolt holes	diam. of bolts [#]	diam. of bolt circle	length of bolts			length thru hub		
								stud [†]		male & female tongue & groove	welding neck Y	slip-on, th'rd Y	lap joint Y
								1/4" raised face	ring joint				
1/2	4 3/4	7/8	1 3/8	1 1/2	4	3/4	3 3/4	4	4	3 3/4	2 3/8	1 1/4	1 1/4
3/4	5 1/8	1	1 11/16	1 3/4	4	3/4	3 1/2	4 1/4	4 1/4	4	2 3/4	1 3/8	1 3/8
1	5 7/8	1 1/8	2	2 1/16	4	7/8	4	4 3/4	4 3/4	4 1/2	2 7/8	1 3/8	1 3/8
1 1/4	6 1/4	1 1/8	2 1/2	2 1/2	4	7/8	4 3/8	4 3/4	4 3/4	4 1/2	2 7/8	1 5/8	1 5/8
1 1/2	7	1 1/4	2 7/8	2 3/4	4	1	4 7/8	5 1/4	5 1/4	5	3 1/4	1 3/4	1 3/4
2 *	8 1/2	1 1/2	3 5/8	4 1/8	8	7/8	6 1/2	5 1/2	5 3/4	5 1/4	4	2 1/4	2 1/4
2 1/2	9 5/8	1 5/8	4 1/8	4 7/8	8	1	7 1/2	6	6 1/4	5 3/4	4 1/8	2 1/2	2 1/2
3	11 1/2	2	5	5	8	7/8	7 1/2	5 1/2	5 3/4	5 1/4	4	2 3/8	2 3/8
4	11 1/2	2 1/4	6 3/16	6 1/4	8	1 1/8	9 1/4	6 1/2	6 3/4	6 1/4	4 1/2	2 3/4	2 3/4
5	13 3/4	2 1/2	7 5/16	7 1/2	8	1 1/4	11	7 1/4	7 1/2	7	5	3 3/8	3 3/8
6	15	2 5/8	8 1/2	9 1/4	12	1 1/8	12 1/2	7 1/2	7 1/2	7 1/4	5 1/2	3 3/8	3 3/8
8	18 1/2	3	10 5/8	11 3/4	12	1 3/8	15 1/2	8 1/2	8 3/4	8 1/4	6 3/8	4	4 1/2
10	21 1/2	3 1/4	12 3/4	14 1/2	16	1 5/8	18 1/2	9	9 1/4	8 3/4	7 1/4	4 1/4	5
12	24	3 5/8	15	16 1/2	20	1 7/8	21	9 3/4	10	9 1/2	7 3/8	4 5/8	5 3/8
14	25 1/4	3 3/4	16 1/4	17 3/4	20	1 1/2	22	10 1/2	11	10 1/4	8 3/8	5 1/8	6 1/8
16	27 3/4	4	18 1/2	20	20	1 5/8	24 1/4	11	11 1/2	10 3/4	8 1/2	5 1/4	6 1/2
18	31	4 1/4	21	22 1/4	20	1 7/8	27	12 3/4	13 1/4	12 1/2	9	6	7 1/2
20	33 3/4	4 3/4	23	24 1/2	20	2	29 1/2	13 1/2	14	13 1/4	9 3/4	6 1/4	8 1/4
24	41	5 1/2	27 1/4	29 1/2	20	2 1/2	35 1/2	17	17 3/4	16 3/4	11 1/2	8	10 1/2
26	42 3/4	5 1/2	29 1/2	30 1/2	20	2 3/4	37 1/2	17 1/2	18 3/4	-----	11 3/4	11 1/4	-----
28	46	5 3/8	31 1/2	32 3/4	20	3	40 1/4	18 1/4	19 1/2	-----	11 3/4	11 3/4	-----
30	48 1/2	5 7/8	33 3/4	35	20	3	42 3/4	18 3/4	20	-----	12 1/4	12 1/4	-----
32	51 3/4	6 1/4	36	37 1/4	20	3 1/4	45 1/2	20	21 1/4	-----	13	13	-----
34	55	6 1/2	38	39 5/8	20	3 1/2	48 1/4	21	22 1/2	-----	13 3/4	13 3/4	-----
36	57 1/2	6 3/4	40 1/4	41 7/8	20	3 1/2	50 3/4	21 1/2	23	-----	14 1/4	14 1/4	-----

900 lb flange

lap joint

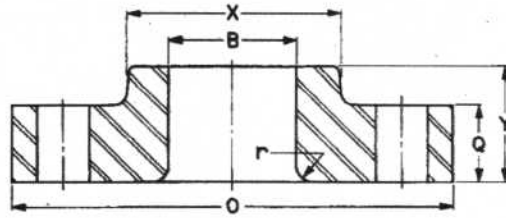

slip-on

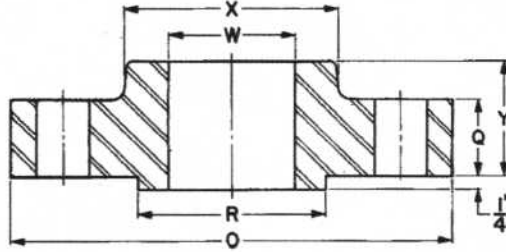

blind

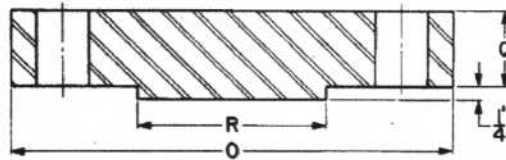

nominal pipe size	diameter of bore				minimum thread length T ₊	diam. of hub at point of welding H	radius r	weight (approx.) lb			
	threaded counter bore C	lap joint B	slip-on W	welding neck J _φ				welding neck	slip-on and threaded	lap joint	blind
1/2	.93	.90	.88		3/8	.84	1/8	7	9	9	4
3/4	1.14	1.11	1.09	as	1	1.05	1/8	7	9	9	6
1	1.41	1.38	1.36		1 1/8	1.32	1/8	9	9	9	9
1 1/4	1.75	1.72	1.70		1 3/8	1.66	3/16	10	10	10	10
1 1/2	1.99	1.97	1.95	speci-	1 1/4	1.90	1/4	14	14	14	14
2	2.50	2.46	2.44		1 1/2	2.38	3/16	25	25	25	25
2 1/2	3.00	2.97	2.94		1 7/8	2.88	3/16	36	36	35	35
3	3.63	3.60	3.57	fied	1 5/8	3.50	3/8	32	31	30	32
4	4.63	4.60	4.57		1 3/4	4.50	3/16	51	53	51	54
5	5.69	5.69	5.66	by	2 1/8	5.56	3/16	86	83	81	87
6	6.75	6.75	6.72		2 1/4	6.63	1/2	110	108	105	113
8	8.75	8.75	8.72		2 1/2	8.63	1/2	187	172	188	197
10	10.88	10.92	10.88		2 3/8	10.75	1/2	268	245	277	290
12	12.94	12.92	12.88		3	12.75	1/2	372	326	371	413
14	14.19	14.18	14.14		3 1/4	14.00	1/2	562	380	397	494
16	16.19	16.19	16.16		3 3/8	16.00	1/2	685	459	488	619
18	18.19	18.20	18.18		3 1/2	18.00	1/2	924	647	670	880
20	20.19	20.25	20.20		3 5/8	20.00	1/2	1164	792	868	1107
24	24.19	24.25	24.25		4	24.00	1/2	2107	1480	1659	2099
26	26.25	pur-	26 5/8	1575	1525	2200
28	28.25		28 1 1/8	1850	1800	2575
30	30.25		30 3/4	2150	2075	3025
32	32.25	chaser	32 3/4	2575	2500	3650
34	34.25		34 1 3/8	3025	2950	4275
36	36.25		36 3/8	3450	3350	4900