

90° elbow short radius

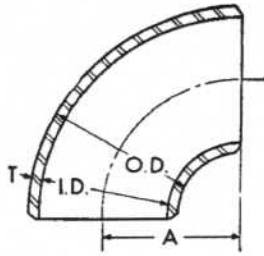

dimensions: All dimensions are in inches and in accordance with ASA B16.28 where established.

pressure-temperature ratings: Identical with those of seamless pipe of the same size, thickness and material grade.

footnotes: *Pipe schedule numbers in accordance with ASA B36.10.

▲This size or

nominal pipe size	outside diameter O. D.	inside diameter I. D.	wall thickness T	center to face A	pipe schedule number*	weight (approx) lb
standard						
1	1.315	1.049	.133	1	40	.3
1¼	1.660	1.380	.140	1¼	40	.4
1½	1.900	1.610	.145	1½	40	.6
2	2.375	2.067	.154	2	40	1.0
2½	2.875	2.469	.203	2½	40	2.2
3	3.500	3.068	.216	3	40	3.3
3½	4.000	3.548	.226	3½	40	4.2
4	4.500	4.026	.237	4	40	6.7
5	5.563	5.047	.258	5	40	10.4
6	6.625	6.065	.280	6	40	16.6
8	8.625	7.981	.322	8	40	34.5
10	10.750	10.020	.365	10	40	62.3
12	12.750	12.000	.375	12	▲	82
14	14.000	13.250	.375	14	30	108
16	16.000	15.250	.375	16	30	135
18	18.000	17.250	.375	18	▲	176
20	20.000	19.250	.375	20	20	238
22	22.000	21.250	.375	22	▲	256
24	24.000	23.250	.375	24	20	305
26	26.000	25.250	.375	26	▲	359
28	28.000	27.250	.375	28	▲	415
30	30.000	29.250	.375	30	▲	470
32	32.000	31.250	.375	32	▲	546
34	34.000	33.250	.375	34	▲	617
36	36.000	35.250	.375	36	▲	692
42	42.000	41.250	.375	48	▲	1079
extra strong						
1½	1.900	1.500	.200	1½	80	.8
2	2.375	1.939	.218	2	80	1.4
2½	2.875	2.323	.276	2½	80	2.5
3	3.500	2.900	.300	3	80	4.1
3½	4.000	3.364	.318	3½	80	5.7
4	4.500	3.826	.337	4	80	8.3
5	5.563	4.813	.375	5	80	14.5
6	6.625	5.761	.432	6	80	22.9
8	8.625	7.625	.500	8	80	50.2
10	10.750	9.750	.500	10	60	74
12	12.750	11.750	.500	12	▲	104
14	14.000	13.000	.500	14	▲	135
16	16.000	15.000	.500	16	40	177
18	18.000	17.000	.500	18	▲	225
20	20.000	19.000	.500	20	30	276
22	22.000	21.000	.500	22	▲	338
24	24.000	23.000	.500	24	▲	404
26	26.000	25.000	.500	26	▲	474
28	28.000	27.000	.500	28	▲	551
30	30.000	29.000	.500	30	20	644
32	32.000	31.000	.500	32	▲	722
34	34.000	33.000	.500	34	▲	817
36	36.000	35.000	.500	36	▲	913
42	42.000	41.000	.500	48	▲	1430